

INFRASTRUCTURE WORK

ON RUE PARÉ,

BETWEEN AVENUE MOUNTAIN SIGHTS AND AVENUE VICTORIA

NOTICE TO RESIDENTS

On April 27, 2017, the Côte-des-Neiges–Notre-Dame-de-Grâce Borough will resume infrastructure work **on rue Paré**, from avenue Mountain Sights to avenue Victoria.

Details of work operations:

- Work operations on the south side of rue Paré
- Local traffic on rue Paré, one-way only from avenue Victoria toward avenue Mountain Sights
- Detour via rue de la Savane and Jean-Talon Est
- Parking on some places only on the north side of rue Paré
- Zone for parking stickers on the south side moved to the north side
- Work crews on site Monday to Friday from 7 a.m. to 7 p.m.
- Certain work operations carried out on weekends
- Access to properties and establishments in the sector maintained at all times
- Pedestrian traffic maintained on the north side of rue Paré

Pedestrians, cyclists and motorists are asked to respect the signage, be attentive to other users, and exercise caution and patience when circulating in the area.

We are doing everything we can to mitigate any inconveniences that may be brought about by these work operations.

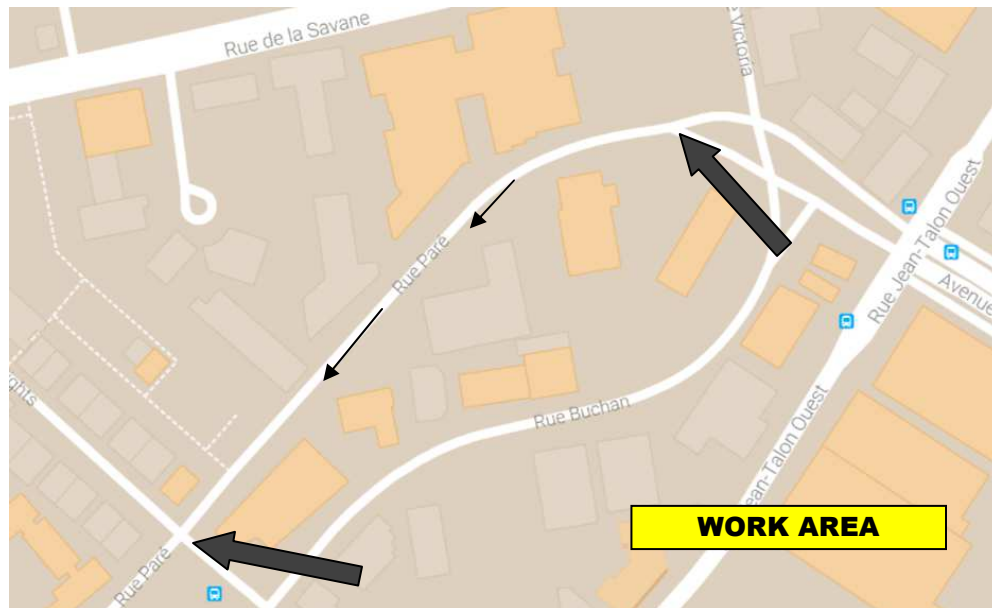

 Any major problem should be reported to the Accès Montréal office by dialing 311.

STAY CONNECTED TO YOUR BOROUGH

